

Elevator Bolts

Bolting Sets Options



For buckets with recessed holes use: Bolt, hexagon nut, spring washer; and **domed washer**.



For plastic buckets with flat holes use: Bolt, hexagon nut, spring washer and **large flat washer**.



For steel buckets with flat holes use: Bolt, hexagon nut, spring washer and **small flat washer**.

Fang Bolts

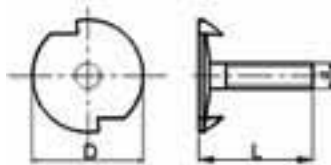

FEATURES

- With 2 fangs on the head for better biting into the belt, to prevent from rotation when tightening.
- Available in Carbon Steel (Galvanized).

SPECIFICATIONS

Size (Nominal)	Diameter of Head (mm) D	Length (L)						
		25 (mm)	30 (mm)	35 (mm)	38 (mm)	40 (mm)	45 (mm)	50 (mm)
M6	25	1.07	1.17	1.25	1.34			
M8	27		1.85	1.97	2.23	2.25	2.35	
M10	31		3.16	3.26		3.37	3.81	3.94

Note: Customized length is available on request.

Euro Bolts

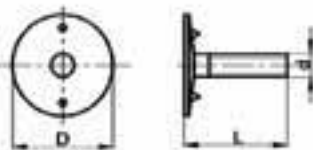

FEATURES

- 2 raised lugs on the bolt head to prevent rotation when tightening.
- Available in Carbon Steel (Galvanized).

SPECIFICATIONS

Size (Nominal)	Diameter of Head (mm) D	Length (L)								
		20 (mm)	25 (mm)	30 (mm)	35 (mm)	40 (mm)	45 (mm)	50 (mm)	60 (mm)	70 (mm)
M6	25	0.95	1.04	1.13						
M8	30	1.67	1.82	1.98	2.14	2.29	2.45	2.60		
M10	32		3.15	3.40	3.64	3.89	4.14	4.38		
M12	40				4.73	5.09	5.45	5.80	6.52	7.23

Note: Customized length is available on request.

Ordinary Bolts

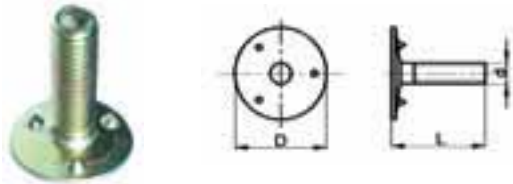

FEATURES

- 3 raised lugs on the bolt head to prevent rotation when tightening.
- Available in Carbon Steel (Galvanized).

SPECIFICATIONS

Size (Nominal)	Diameter of Head (mm) D	Length (L)				
		16 (mm)	22 (mm)	25 (mm)	30 (mm)	38 (mm)
M6	17	0.55	0.73	0.75	0.88	
M8	23			1.35	1.55	1.86

Note: Customized length is available on request.

No.1 Norway Bolts

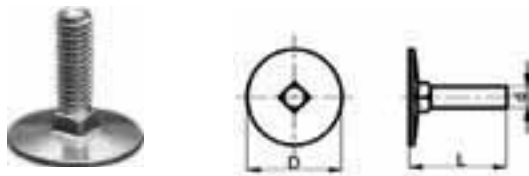

FEATURES

- With cuboid transition between head and screw, to strengthen the bolt head and prevent from rotation when tightening by locking into the belt punching holes.
- Available in Carbon Steel (Galvanized).

SPECIFICATIONS

Size (Nominal)	Diameter of Head (Inches) D	Length (L)				
		1"	1-1/4"	1-1/2"	1-3/4"	2"
1/4"	1"	1.07	1.18	1.29		1.51
5/16"	1-3/16"	1.82	2.02	2.22	2.41	2.61
3/8"	1-1/4"	2.98	3.29	3.60		4.22

Note: Customized length is available on request.

Bolts Accessories

Item	Size (Nominal)		T (mm)	Kg (100pcs)
	Metric	Imperial		
Domed Washer	M6	1/4"	1.6	0.34
	M8	5/16"	2.0	0.57
	M10	3/8"	2.5	1.16
	M12	1/2"	2.5	1.9
Small Flat Washer	M6	1/4"	1.6	0.11
	M8	5/16"	1.6	0.19
	M10	3/8"	2	0.37
	M12	1/2"	2.5	0.67
Hexagon Nut	M6	1/4"	5.2	0.21
	M8	5/16"	6.8	0.45
	M10	3/8"	8.4	0.84
	M12	1/2"	10.8	1.25

Item	Size (Nominal)		T (mm)	Kg (100pcs)
	Metric	Imperial		
Large Flat Washer	M6	1/4"	1.6	0.27
	M8	5/16"	2	0.61
	M10	3/8"	2.5	1.2
	M12	1/2"	3	2.19
Spring Washer	M6	1/4"	1.6	0.05
	M8	5/16"	2.1	0.11
	M10	3/8"	2.6	0.21
	M12	1/2"	3.1	0.36
Nyloc Nut	M6	1/4"	8	0.22
	M8	5/16"	9.5	0.46
	M10	3/8"	11.9	0.86
	M12	1/2"	14.9	1.28

Material: Carbon Steel (Galvanized), only for Spring Washer, it's made from Manganese Steel.